

# HYX-LOGGER

HYX-LoggerA / HYX-LoggerB

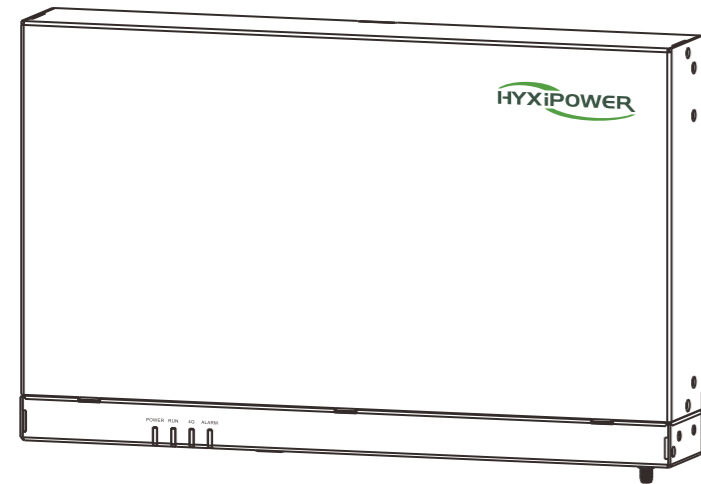

## 1 Product Introduction

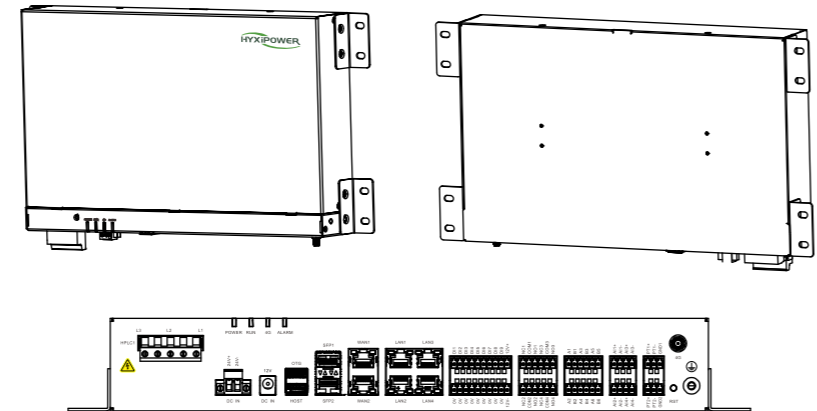

## 2 Installation Introduction

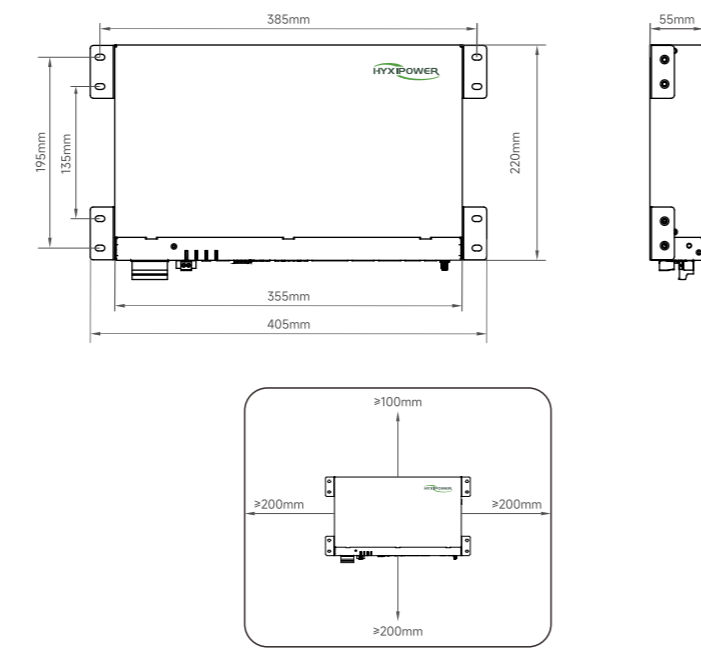

## 3 Equipment installation

### 3.1 Wall-mounted installation

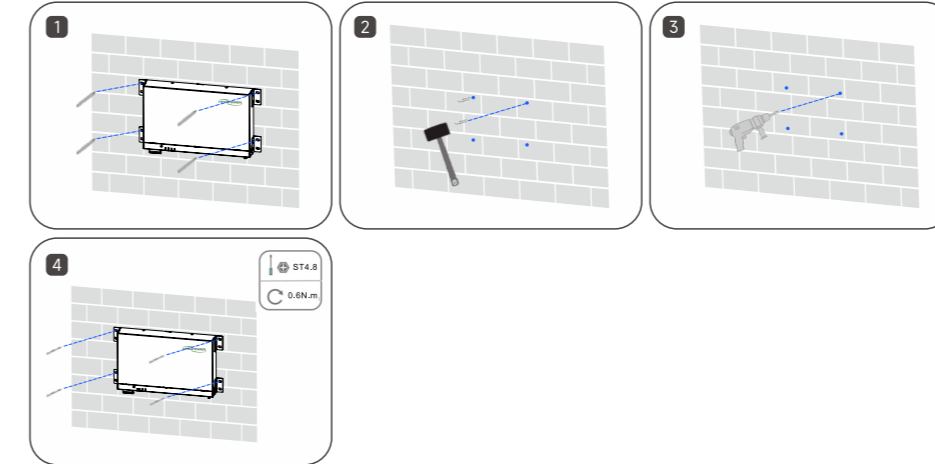

### 3.2 Lead rail installation

- Before installation, please provide your own 35mm standard lead rail and install it firmly.
- The effective length of the recommended lead rail is ≥360mm.
- M3 fastening screw.

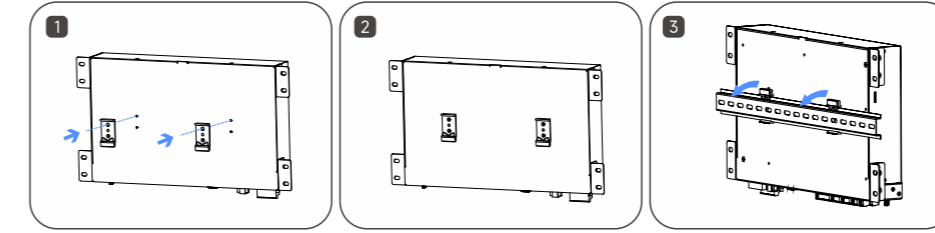

## 4 Electrical connection

### 4.1 Terminal Introduction

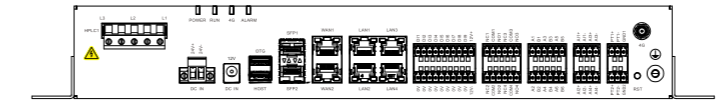

Attention:  
Electrical connections must comply with the laws and regulations of the local country or region. To prevent the cables from being subjected to excessive tensile force and resulting in poor connection, it is recommended to reserve a margin for the cables before connecting them to the corresponding ports.

Type	Recommended Specification
PE	Outdoor copper core cables with a cross-sectional area of 4mm <sup>2</sup> - 6mm <sup>2</sup> or 12AWG - 10AWG
RS485 Cable	Outdoor shielded double-core or multi-core cables with a cross-sectional area of 0.5mm <sup>2</sup> - 2.5mm <sup>2</sup> or 14AWG - 24AWG
HPLC communication cable	0.5mm <sup>2</sup> - 2.5mm <sup>2</sup> , Cable withstand voltage: cable grounding working voltage ≥1000V
DI signal line	Double-core or multi-core cables with a cross-sectional area of 0.5mm <sup>2</sup> - 1.5mm <sup>2</sup> or 24AWG - 16AWG
DO signal line	Double-core or multi-core cables with a cross-sectional area of 0.5mm <sup>2</sup> - 1.5mm <sup>2</sup> or 24AWG - 16AWG
AI signal line	Double-core or multi-core cables with a cross-sectional area of 0.5mm <sup>2</sup> - 1.5mm <sup>2</sup> or 24AWG - 16AWG

Type	Recommended Specification
Power output cable	Double-core or multi-core cables with a cross-sectional area of 0.5mm <sup>2</sup> - 1.5mm <sup>2</sup> or 24AWG - 16AWG
AC input cable	1-1.5mm <sup>2</sup> outdoor UV-resistant copper wire, connected to 100-277Vac (50/60Hz), current ≤0.48A
Network cable	A Cat 5e or higher cable and a shielded connector are recommended

### 4.2 Install PE cable

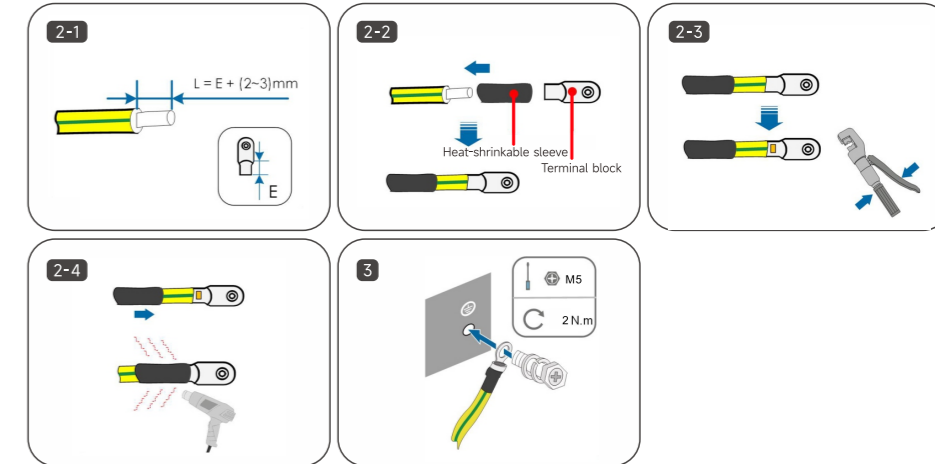

### 4.3 Install RS485 cable

- Notice:
1. It is recommended that the RS485 communication cable should not exceed 1000m.
  2. HYX-Logger can be connected to RS485 communication devices such as inverters and electricity meters through the COM port.
  3. Please ensure that RS485+ is connected to HYX-LoggerA's A1 and RS485- is connected to HYX-LoggerA's B1.

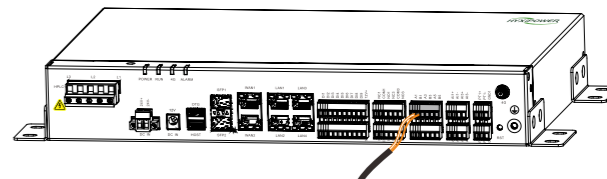
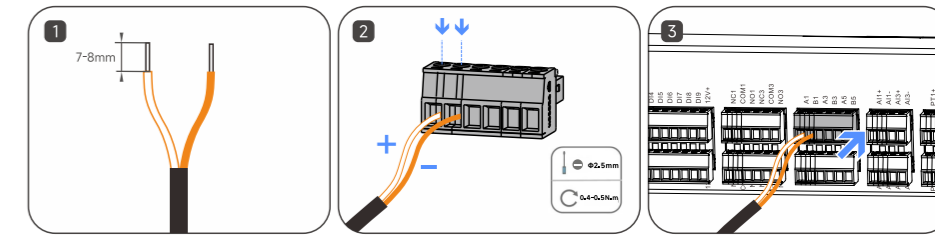

### RS485 connection

- Notice:
1. It is recommended that the number of devices connected to each RS485 line be less than 30.
  2. The baud rate, communication protocol and verification mode of all devices on each RS485 cascade link must be consistent with the RS485 communication parameters on the corresponding COM port of HYX-Logger.

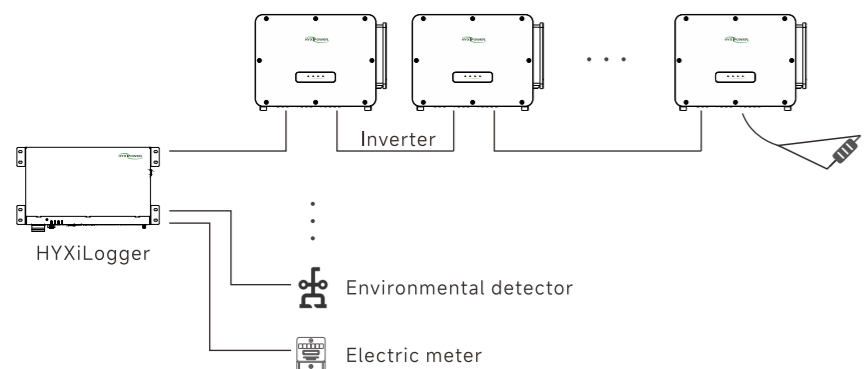

#### 4.4 Install the HPLC cable

Notice:

1. Disconnect the transformer from the power grid before wiring; Disconnect the inverter from the DC side; Ensure that the system is within the safe operating range.
2. When the inverter uses HPLC communication, it does not need to use RS485 cable communication.
3. When using HPLC communication mode, the distance between the inverter and the data acquisition unit cannot exceed 1000m.

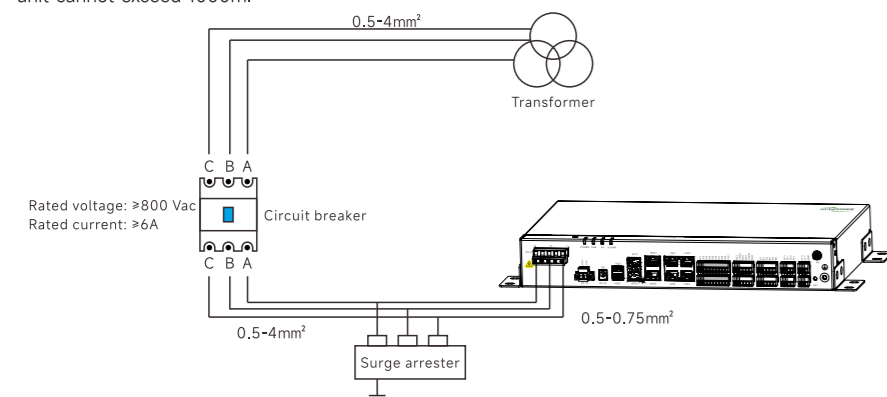

#### 4.5 Install the DI signal cable

Notice:

1. HYLX-Logger can connect remote power grid dispatching commands, alarms and other DI signals through the DI signal port, and only supports passive dry contact signal connection.
2. And signal transmission distance is not more than 10 m.

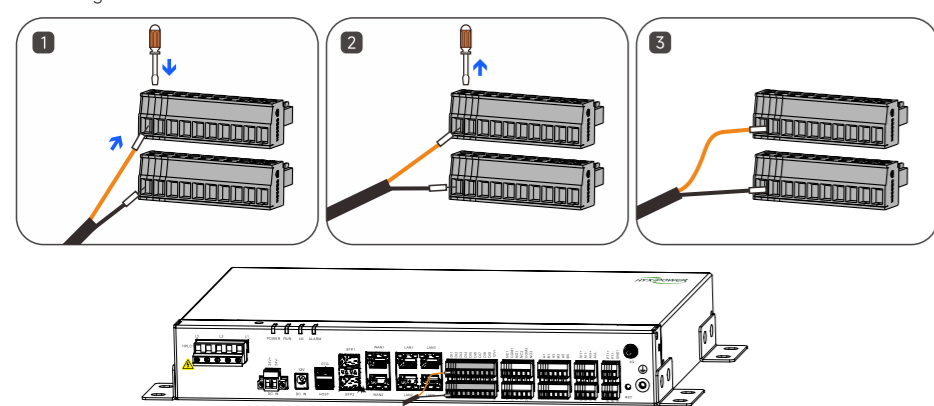

#### 4.6 Install the DO signal cable

Notice:

1. The maximum signal voltage of DO port is 12V. NC/COM is normally closed contact, and NO/COM is normally open contact.
2. And signal transmission distance is not more than 10 m.
3. Refer to the wiring steps of the DI signal.

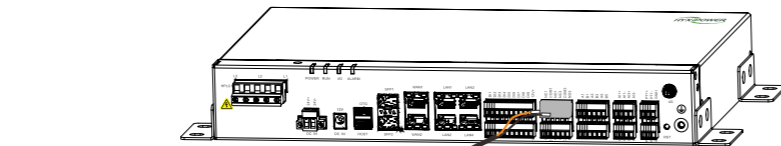
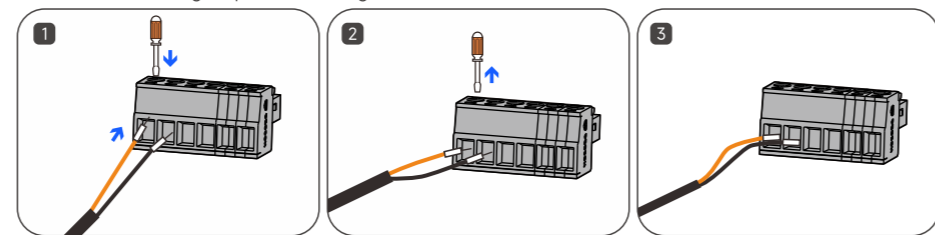

#### 4.7 Install the AI signal cable

Notice:

1. The AI signal of the environmental detection sensor can be connected through the AI port.
2. And signal transmission distance is not more than 10 m.
3. Refer to the wiring steps of the DI signal.

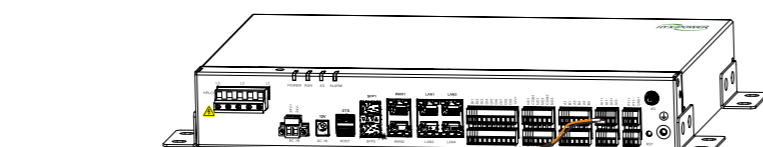
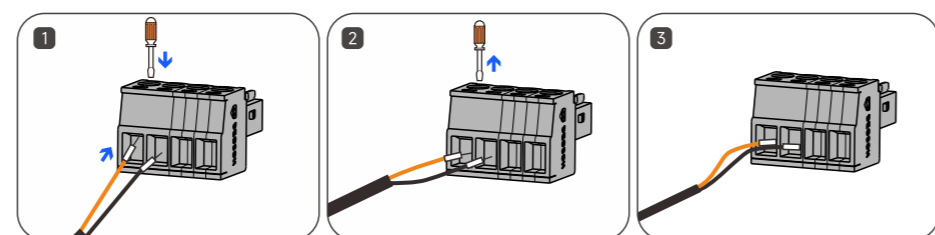

#### 4.8 Install the PT signal cable

Notice:

1. Refer to the wiring steps of the DI signal.
2. Connect the 3-wire PT100/PT1000.

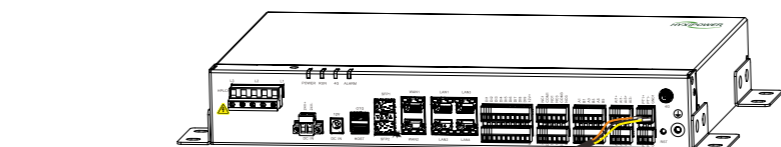
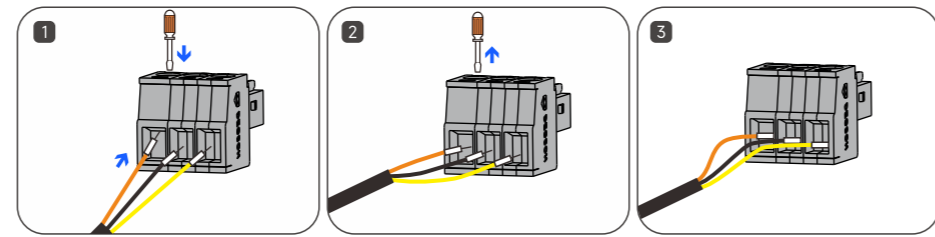

3. Connect the 2-wire PT100/PT1000.

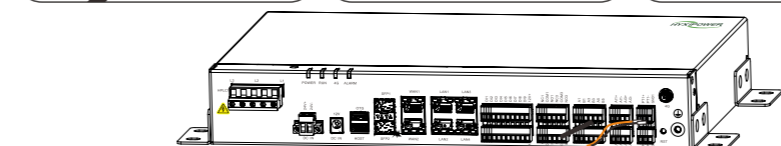
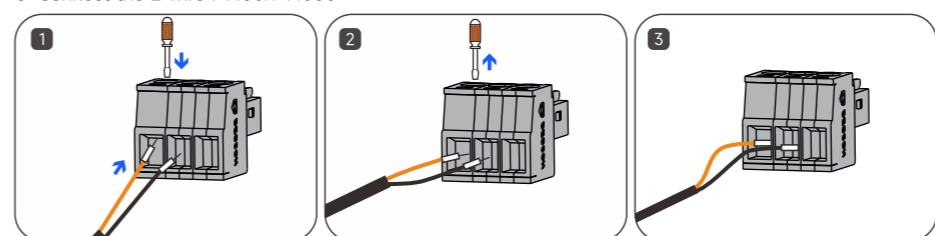

#### 4.9 Installing Network Cables

HYX-Logger can connect to Ethernet, routers, computers and other devices through the WAN port. HYX-Logger can be connected to other devices or computers via a LAN port.

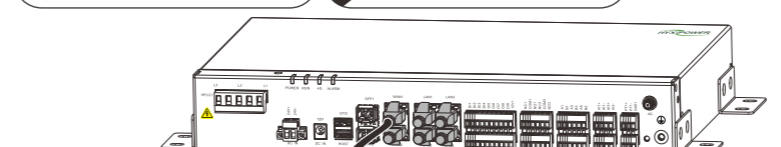
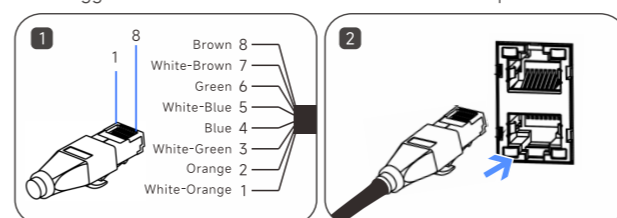

#### 4.10 Install optical patch cords

HYX-LoggerA can connect devices such as optical cable terminal boxes through optical fiber cables. The optical fiber module is optional, such as self-configuration, according to the optical switch port select 100 MBPS or gigabit module, and the module uses SFP package or eSFP seal. The transmission distance supported by the 100 MBPS optical module is ≥12km, and the transmission distance supported by the Gigabit optical module is ≥10km

When inserting the optical fiber module into the SFP1 port, please ensure that the labeled side is facing up. When inserting the optical fiber module into the SFP2 port, please ensure that the labeled side is facing down.

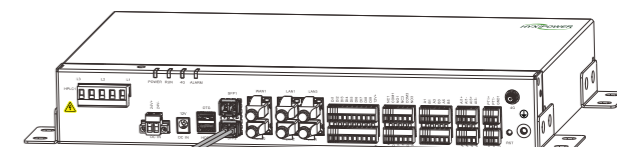
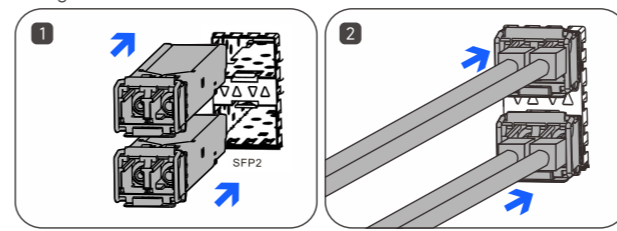

#### 4.11 Install SIM card (Only for the HYX-LoggerA version)

Notice:

Please bring a standard SIM card (size: 15mm×25mm, capacity ≥64KB). The monthly data traffic of the SIM card is ≥ the monthly data traffic of the inverter + the monthly data traffic of the environmental monitor. The installation direction of the SIM card can be determined by the silk-screen printing at the SIM card socket.

1. When the SIM card is pressed to the limit, the SIM card will lock. At this time, the SIM card has been installed correctly.
2. When the SIM card is removed, the SIM card can be pushed inward, and the SIM card will automatically pop out.

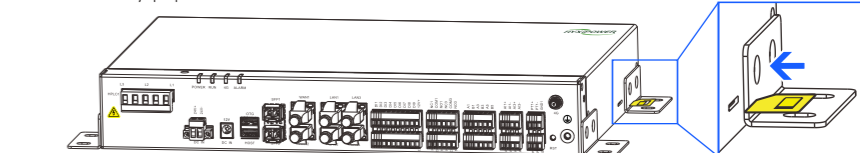

#### 4.12 Install the DC input cable

Notice:

It is powered by a 24V DC power supply and can be used as a backup power source.

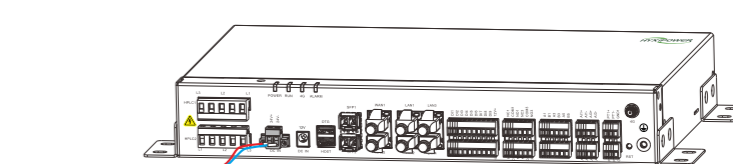
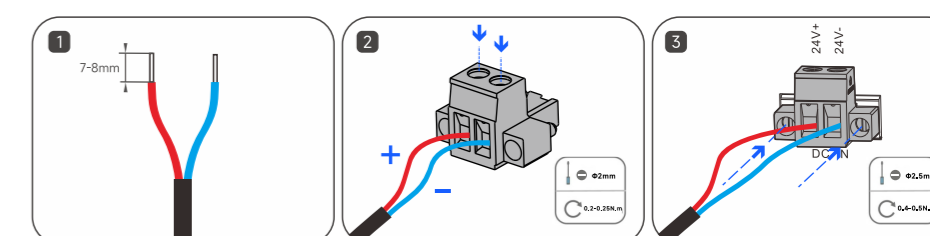

## 5 HYX-Logger Debugging

For equipment debugging, please refer to the "HYX-Logger" user manual. Scan the code to obtain it.

support@hyxipower.com

Product information is subject to change without notice.  
© 2026 Zhejiang Hyxi Technology Co., Ltd. All rights reserved.

6.2.5118.00XXX  
QJ\_HYX-LoggerA/B\_Quick Guide\_V1.0-202601\_EN