

DATA COMMUNICATION STICK

HYX-DCS-4G-A
HYX-DCS-WL-A

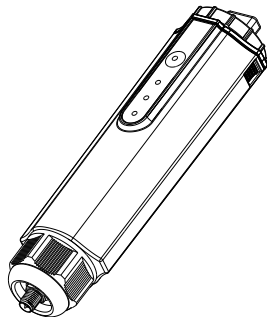

1 Installation Preparation

WIFI Module (Model: HYX-DCS-WL-A)

- Step 1: Connecting the tail end of the DCS to the head of the antenna.
- Step 2: Insert DCS into the DONGLE terminal and tighten it to ensure it is secure.

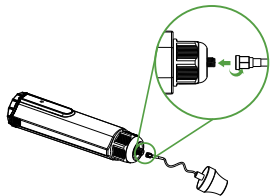

Step 1

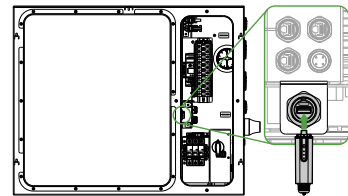

Step 2

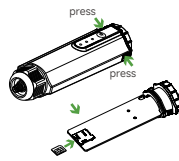

Step 1

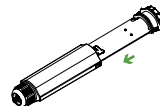

Step 2

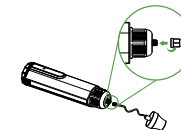

Step 3

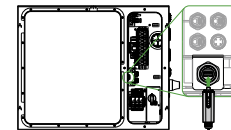

Step 4

4G Module (Model: HYX-DCS-4G-A)

- Step 1: Remove the protective cover of DCS and insert the SIM card.
- Step 2: Install the waterproof cover of DCS.
- Step 3: Connecting the tail end of the DCS to the head of the antenna.
- Step 4: Insert DCS into the DONGLE terminal and tighten it to ensure it is secure.

2 System Commissioning

2.1 Installing the App

Method 1

Download the "HYXiPOWER APP" from the app store:

- App Store (IOS)
- Google Play

Method 2

Scan the QR code and download the APP:



App Download

2.2 System Debugging

For more information on using the HYXiPOWER APP, please refer to the user manual "HYXiPOWER APP".
For system configuration and debugging, please refer to the user manual "HYXiPOWER Local Debugging APP".



HYXiPOWER APP



Local Debugging APP

3 Introduction of Indicator Lights

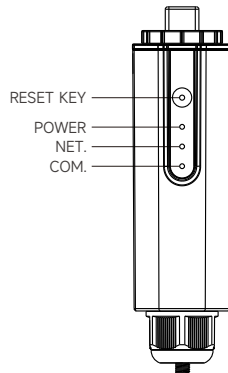

Indicator	Status	Description
POWER	ON	Power ON
	OFF	Power OFF
NET	Solid Green	Connected to the server
	Flashing	Connecting to the server
	OFF	Disconnected from the server
COM	Solid Green	Normal communication with inverter
	Flashing	Communicating with the inverter
	OFF	Communication with inverter failed

* Reset Button:

Press 2 times to restart,
Press 4 times to restore factory settings (Within 1 second between pressing).

Product information is subject to change without notice.

© 2024 Zhejiang Hyxi Technology Co., Ltd. All rights reserved.

6.2.51.18.00136

QI_HYX-DCS-4G(WL)-A_V1.1-202412_EU



www.hyxipower.com

Zhejiang Hyxi Technology Co., Ltd.